

AS1 AC RETROFIT STORAGE SYSTEM

Adapt the existing on-grid solar system to an energy storage one

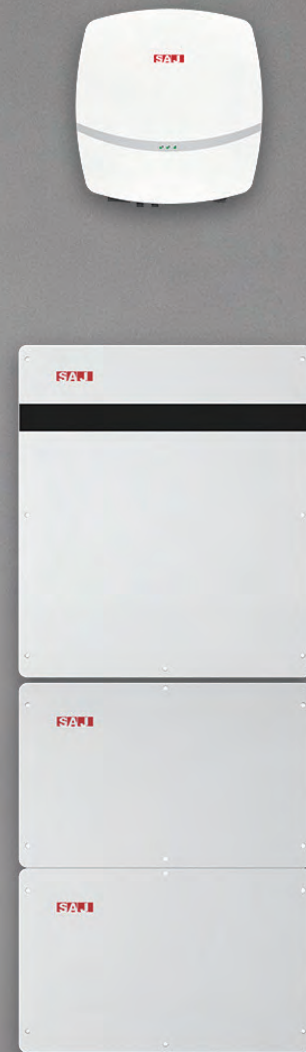

AC Retrofit Battery System Working Modes

1 Self-consumption mode

Under self-consumption mode, the inverter is capable of powering loads first and saving surplus energy from photovoltaic system to battery and can be called on at any time. the excess energy can be exported to grid.

2 Time-of-use mode

Battery charging and discharging time can be flexibly set based on your need. It is widely used when there is a peak and valley tariffs to minimize the electricity bills.

3 Backup mode

Under backup mode, the system to release load according to the grid is blackout.

the inverter will deploy power to support backup reserved SOC limit if the

AS1 series is an AC retrofit storage system consisting of a 3kW AC inverter and a 5.12kWh battery. It provides users with great flexibility to upgrade systems to energy storage systems. It helps users to increase energy independence and effectively helps them to save on electricity bills through

existing grid-connected PV smart working modes.

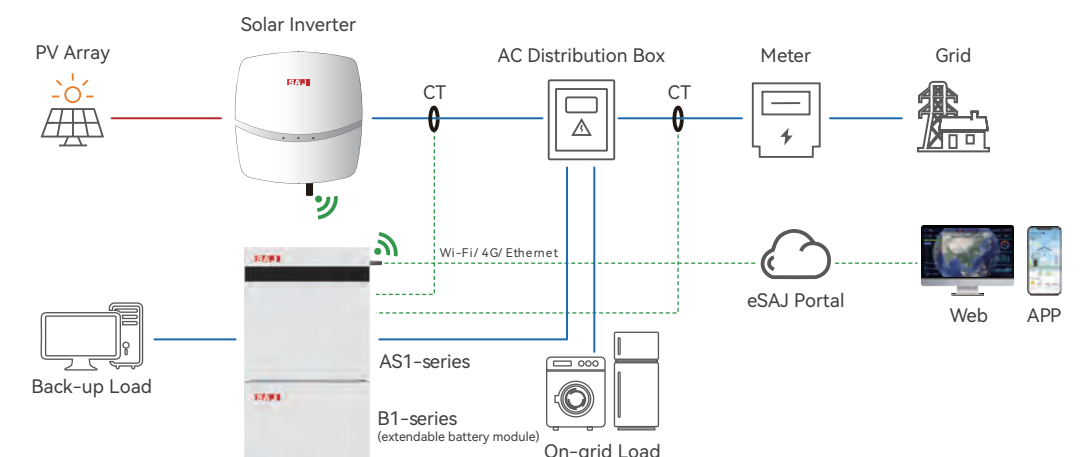

AS1

SERIES

AC-COUPLED RETROFIT INVERTER



AS1-3KS-5.1

- Flexibility in retrofitting the existing system
- Compatible with all inverter brands
- UPS**

With UPS function switch time ≤ 10ms
- Built-in 5.1kWh lithium battery (extendable)
- Fanless design quiet and comfortable
- Easy setting of smart working modes

MODEL	AS1-3KS-5.1
Battery Parameters	
Battery Type	LiFePO4
Total Energy Capacity [kWh]	5.12
Battery Capacity [Ah]	100
Rated Voltage [V]	51.2
Voltage Range [V]	42~58.4
Depth Of Discharge [DOD]	90% (off-grid)
Cycle Life	≥ 6000
Max. Charge Current [A]	60
Max. Discharge Current [A]	60
Scalability	Ja ((up to 20.4kWh)
Grid Parameters	
Max. Continuable Output Power [VA]	3000
Max. Output Current [A]@230Vac	13.1
Rated Grid Voltage/Range [V]	L+N+PE, 220, 230, 240/180 ~ 280
Rated Output Frequency [Hz]	50,60/45 ~ 55,55 ~ 65
Power Factor [cos ϕ]	0.8 leading ~ 0.8 lagging
AC Output [Back-up Mode]	
Max. Continuable Output Power [VA]	3000
Output Voltage [V]	220/230/240
Max. Output Current [A]@230Vac	13.1
Rated Output Frequency [Hz]	50/ 60 ±5
Peak Output Apparent Power [VA]	3600, 10s
General Parameters	
Communication	Wi-Fi/Ethernet/4G (optional)
Operating Temperature Range	0°C~50°C
Cooling Method	Natural convection
Ambient Humidity	0 ~ 95% Non-condensing
Noise [dBA]	< 29
Ingress Protection	IP65
Dimensions [H*W*D][mm]	738*650*186
Weight [kg]	64
Warranty [Year]	5/10/15/20
Applicable Standard	AS 4777.2, VDE 4105, G98, C10/C11, CEI 0-21, IEC 62619, IEC 62040, UN38.3